

LOCATION MAP  
NOT TO SCALE

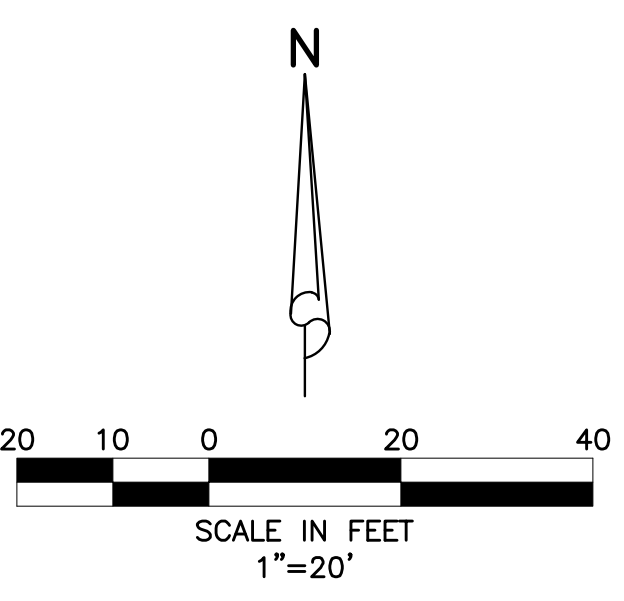

- LEGEND**
- S1-4' MH. MANHOLE NUMBER AND TYPE
  - 19.5 MANHOLE TOP ELEVATION
  - 16.0 MANHOLE INVERT ELEVATION
  - SINGLE SEWER SERVICE W/ CLEAN-OUT
  - DOUBLE SEWER SERVICE W/ CLEAN-OUT
  - SANITARY SEWER LINE, MANHOLE AND DIRECTION OF FLOW
  - FIRE HYDRANT W/ GATE VALVE
  - WATER SERVICE, WATER METER & R.P.Z.
  - WATER MAIN & GATE VALVE
  - GATE VALVE & D.D.C.V. ASSEMBLY

- NOTES:**
- ON-SITE SEWER LATERALS ARE PRIVATELY OWNED AND MAINTAINED.
  - CONTRACTOR TO FIELD VERIFY LOCATION AND DEPTH OF ALL EXISTING UTILITIES PRIOR TO CONSTRUCTION AND NOTIFY ENGINEER OF ANY CONFLICTS. IT SHALL BE THE CONTRACTORS RESPONSIBILITY TO COORDINATE ALL EXISTING UTILITY LOCATES, SUPPORT, RELOCATIONS AND NOTIFICATIONS REQUIRED WITH ALL APPLICABLE UTILITY SERVICE PROVIDERS.
  - CONTRACTOR TO VIDEO INSPECT EXISTING 6" SANITARY SERVICE TO ENSURE SERVICEABILITY.

**DOMESTIC WATER DEMAND:**  
63,788 S.F. BLDG. X 0.10 GRD./S.F. = 6,378.8 G.P.D.

**SANITARY SEWER DEMAND:**  
63,788 S.F. BLDG. X 0.10 GRD./S.F. = 6,378.8 G.P.D.

48 HOURS BEFORE DIGGING  
BROWARD • PALM BEACH • INDIAN RIVER  
ST. LUCIE • MARTIN COUNTIES  
1-800-432-4770  
SUNSHINE STATE 1 CALL  
UNDERGROUND UTILITIES  
NOTIFICATION CENTER

**NOTE:** ALL ELEVATIONS SHOWN HEREON ARE RELATIVE TO THE NORTH AMERICAN VERTICAL DATUM (N.A.V.D.) OF 1988 BASED ON A SURVEY PREPARED BY BROWN & PHILLIPS, INC. (561) 615-3988.

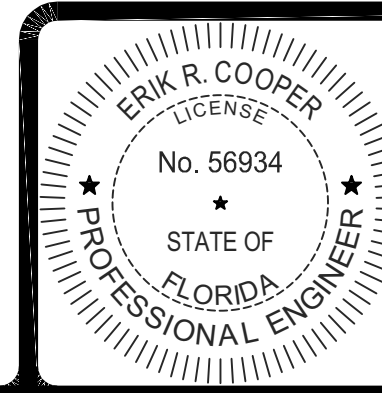

THIS ITEM HAS BEEN DIGITALLY SIGNED AND SEALED BY  
ERIK R. COOPER, P.E. ON  
2/23/2024.

PRINTED COPIES OF THIS DOCUMENT ARE NOT CONSIDERED SIGNED AND SEALED AND THE SIGNATURE MUST BE VERIFIED ON ANY ELECTRONIC COPIES.

REVISIONS	
DESIGN E.C.	DATE
DRAWN B.L.	DATE
CHECKED	DATE
APPROVED	DATE



CHENEY BROTHERS POMPANO BEACH  
SECTION 27, TOWNSHIP 48S, RANGE 42E,  
CITY OF POMPANO BEACH, FLORIDA  
CONCEPTUAL WATER AND WASTE WATER PLAN

2001 N. ANDREWS AVE  
P2218209 2000051  
04/03/2024